

ABELL
SURVEYING & MAPPING

1140 SEQUOIA STREET • DELAVAN, WISCONSIN 53115
262-728-6737

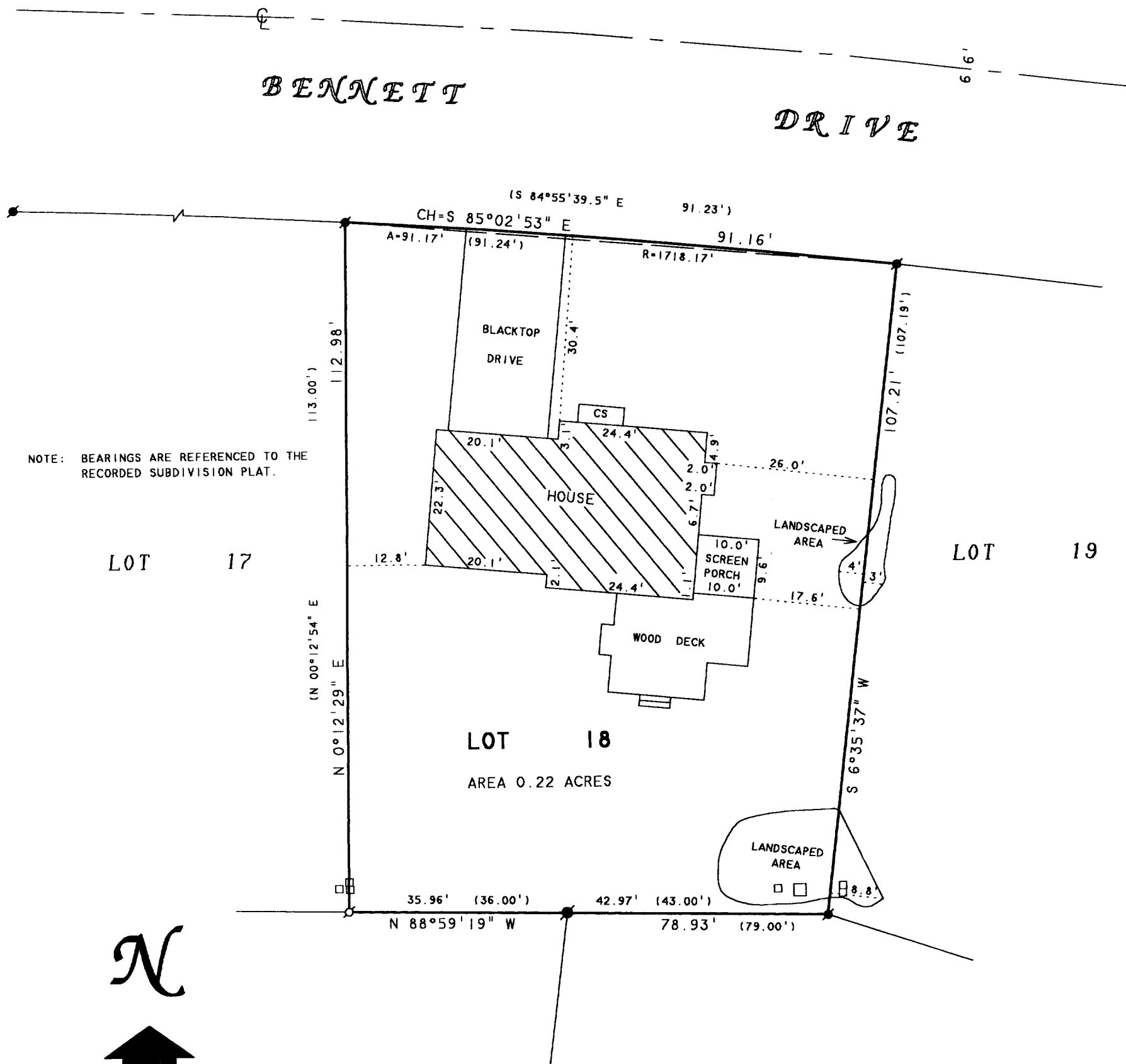

NOTE: BEARINGS ARE REFERENCED TO THE
RECORDED SUBDIVISION PLAT.

N



SCALE 1"=20'

LEGEND

- - IRON PIPE FOUND
- - IRON ROD FOUND
- - IRON BAR FOUND
- CS - CONCRETE STOOP
- - UTILITY PEDS.
- () - RECORDED AS

PLAT OF SURVEY OF

LOT 18, OAK KNOLLS OF WALWORTH, LOCATED IN THE
VILLAGE OF WALWORTH, WALWORTH COUNTY, WISCONSIN.

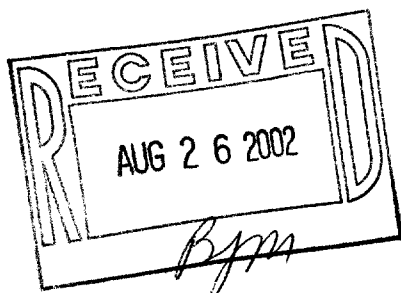

I HEREBY CERTIFY THAT I HAVE SURVEYED THE ABOVE DESCRIBED PROPERTY AND THAT THE
ABOVE MAP IS A TRUE REPRESENTATION THEREOF AND SHOWS THE SIZE AND LOCATION OF
THE PROPERTY, ITS EXTERIOR BOUNDARIES, THE LOCATION OF ALL VISIBLE STRUCTURES
AND DIMENSIONS OF ALL PRINCIPAL BUILDINGS THEREON, BOUNDARY FENCES, APPARENT
EASEMENTS, ROADWAYS AND VISIBLE ENCROACHMENTS, IF ANY, TO THE BEST OF MY
KNOWLEDGE AND BELIEF.

THIS SURVEY IS MADE FOR THE USE OF THE PRESENT OWNERS OF THE PROPERTY, AND ALSO
THOSE WHO PURCHASE, MORTGAGE, OR GUARANTEE THE TITLE THERETO WITHIN ONE (1) YEAR
FROM DATE HEREON.

David F. Abell

DAVID F. ABELL
WISCONSIN REGISTERED LAND SURVEYOR, S-1596

ORDERED BY: THE RAULAND AGENCY
P.O. BOX 159
WALWORTH, WI. 53184

July 19, 2002

DATE: July 19, 2002 JOB NUMBER - 02106
NOTE: THIS IS NOT A CERTIFIED COPY UNLESS SEALED.

VOK 18

009-797